

INSTALLATION INFO for DNA P-BE3N15-01

Application: BENELLI BN302 15'-16' /BENELLI TNT 300 16' /KEEWAY RKX 300 16'

The DNA High Performance Air Filter P-BE3N15-01 is designed to replace the stock BENELLI Foam air filter/TOP plastic supporting frame and increase the Airflow, filtering efficiency, Power, Torque and Throttle response.



It is highly recommended that this installation should be carried out by an experienced mechanic!

1. Remove the stock air filter and the TOP plastic frame from the bike, following the instructions found in the official BENELLI workshop manual.

Be very careful when removing the stock filter and frame, so debris doesn't fall in the clean side of the air box.

ATTENTION: Do not remove the BOTTOM plastic frame, it must be used with the DNA filter.

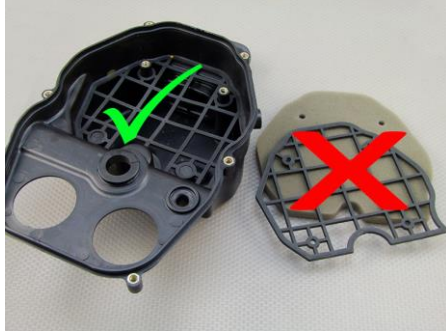

ATTENTION 2: Do not use the top frame!



2. Install the DNA filter and close the air box cover.

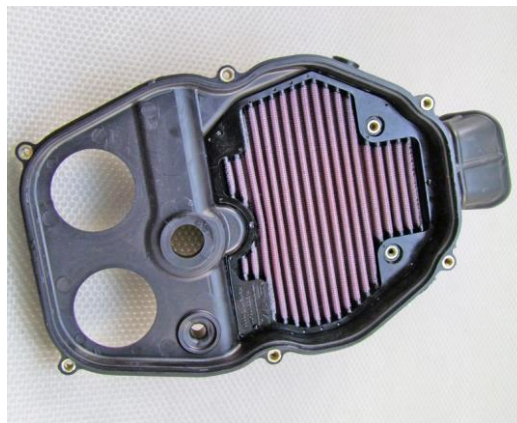

- Follow the above procedure each time you need to remove the DNA filter for servicing it.
Service every 15.000 km or earlier when used in extremely dusty environment.

Use the dedicated DNA Service Kit DSK-2001 (sold separately) to clean and re-oil, following the instructions included with the service kit.

The manufacturer and seller make no warranties express or implied which extend beyond the description of the goods contained herein. Any description of this product is for the purpose of identifying it and shall not be deemed to create an express warranty.