

**INSTALLATION INFO for DNA P-Y4E14-S2**

Application: YAMAHA YZ 250/450 F 2014' ALL

The DNA High Performance Stage 2 Air Filter "Quick Release" Kit P-Y4E14-S2 is designed to replace the stock Air filter and the filter base/spark arrestor.

This S2 Kit consists of a DNA panel filter and 2 laser cut steel frames, including all the necessary hardware for installation.

If used correctly, the S2 kit will increase the Airflow, filtering efficiency, Power, Torque and Throttle response.

*This S2 Air Box Cover Filter is developed for Road, Off road & Race use.*



1. Remove the stock air box & filter from the bike following the instructions found in the official Yamaha workshop manual.



2. Remove the stock foam air filter and the plastic base/spark arrestor.

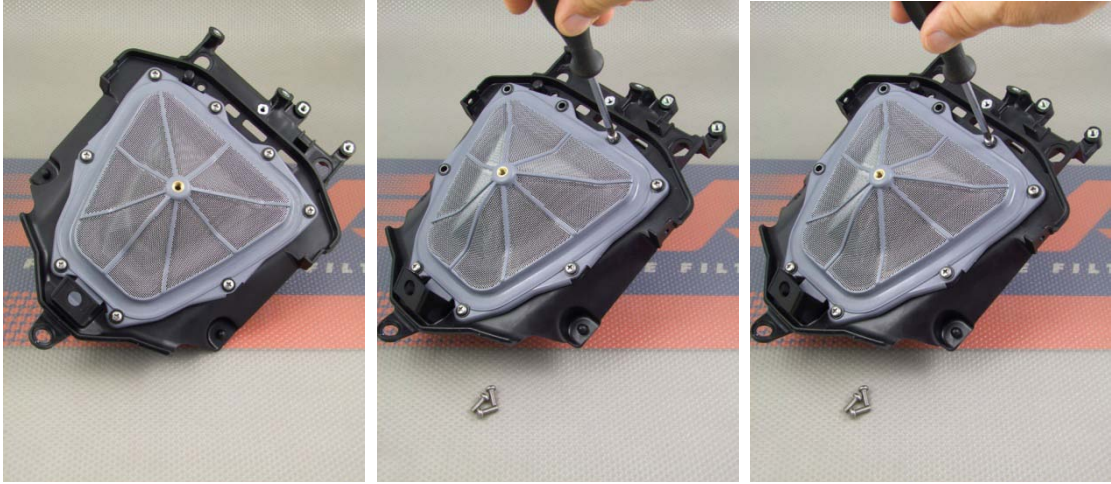

3. Remove all 8 spacers from the stock base. **Attention!** The 8 bolts and spacers will be used with the DNA S2 KIT

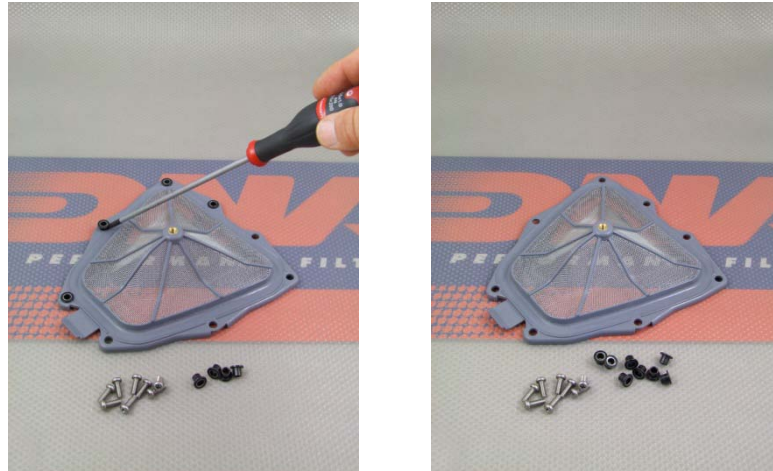

4. Apply DNA Air Filter sealing grease on the stock rubber joint where the DNA steel frame will sit. Install the frame carefully and check if it has been 'centered' with the rubber joint. Install the 8 stock spacers and then bolt the frame using the stock bolts.

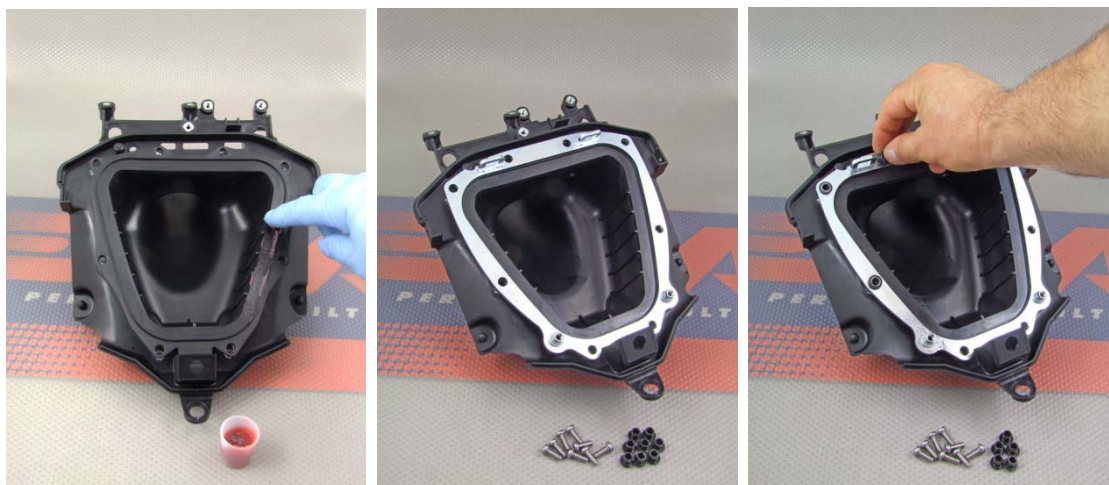

5. Apply again DNA sealing grease to the area the filter will sit.

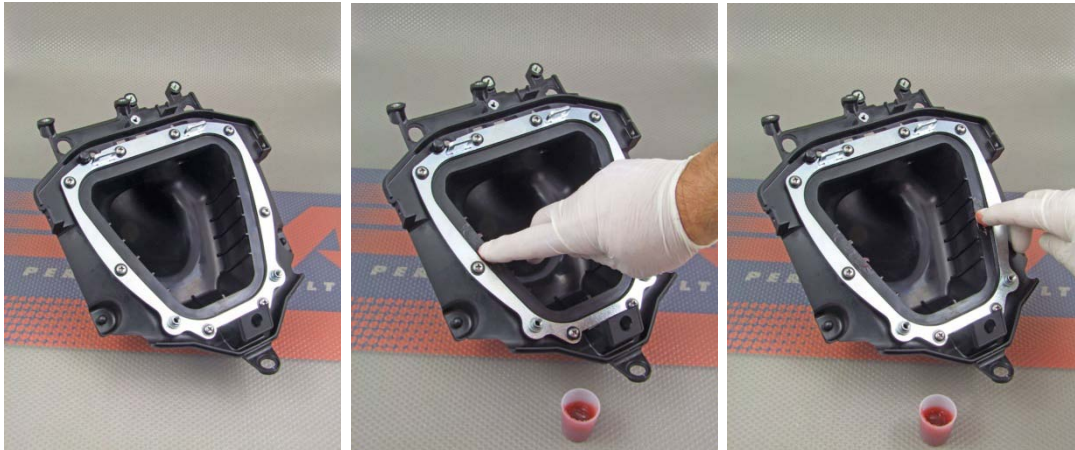

6. Install the top frame on the DNA filter. Pay attention to the locating tab of the filter, it must line up with the notch in the top frame.

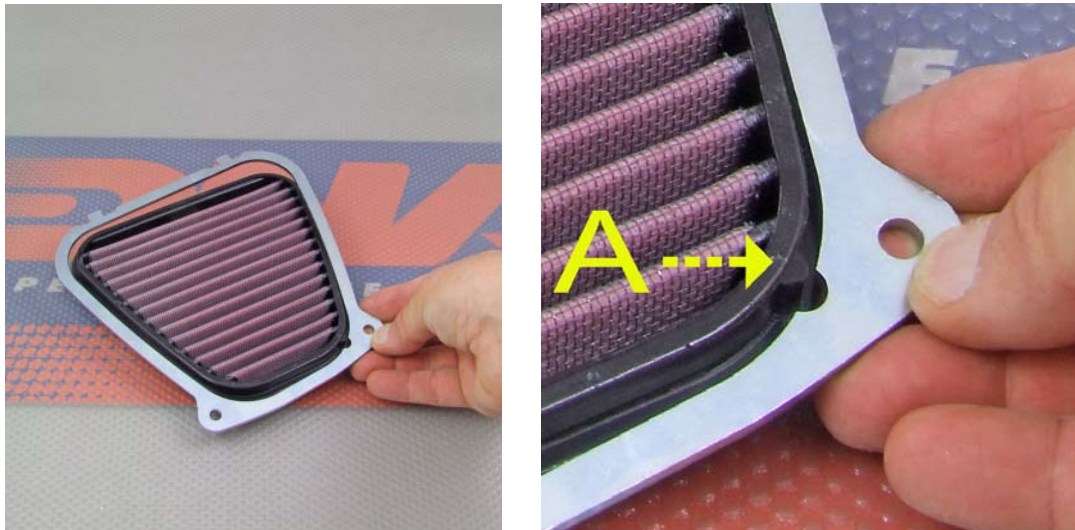

Following slide both, top frame and filter, on the bottom frame and secure using the 2 M6X16 Allen bolts supplied.



7. Congratulations you have successfully completed the installation of your DNA "Quick Release" Stage 2 Kit.

Additional spare filters 'only', without the frames, can be ordered from DNA using the

PN. **P-Y4E14-REP**



Additional spare air filter sealing grease can be ordered from DNA using the

PN. **GR-2002**



- Follow the above procedure each time you service the filters.
- Always use air filter sealing grease to help the filter seal properly.
- Protect the filter when washing the bike and do not use a pressure washer on the filter.
- Use the dedicated DNA Service Kit DSK-2001 (sold separately) to clean and re-oil, following the instructions included with the service kit.

***ATTENTION! Always check and correct your fueling when installing a new filter.***

The manufacturer and seller make no warranties express or implied which extend beyond the description of the goods contained herein. Any description of this product is for the purpose of identifying it and shall not be deemed to create an express warranty.

[www.dnafilts.com](http://www.dnafilts.com)  
[www.facebook.com/dnafilts](https://www.facebook.com/dnafilts)  
[techsupport@dnafilts.com](mailto:techsupport@dnafilts.com)