

SHAD

TRIUMPH TIGER EXPLORER 1200 / TIGER 1200
XR-XRT-XRX-XXR Low-XC-XC_x-XC_a '16-'18

3P
SYSTEM

DESIGNED IN
BARCELONA

T0XP16IF

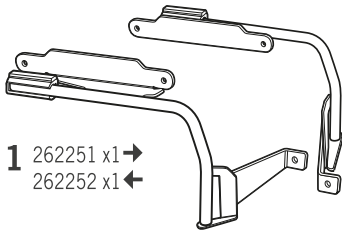

1 262251 x1 →
262252 x1 ←



2 261460 x4
Ø18 Ø11 x 45



3 303045 x8
Ø8

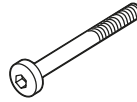

4 304174 x4
M8 x 80
Din 7380



5 303020 x4
Ø8



6 304053 x4
M8 x 30
Din 7380



7 260648 x2
Ø16 Ø9 x 5

! WARNING!

GB Do not fully tighten the screws until it is ensured that the KIT is correctly attached and aligned.

E No apretar los tornillos del todo hasta asegurarse que el KIT está correctamente colocado y alineado.

D Ziehen Sie die Schrauben nicht ganz fest, bevor Sie sich nicht vergewissert haben, daß der Bausatz korrekt eingestellt und ausgerichtet ist.

I Non stringere del tutto le viti fin tanto non si è sicuri che il kit è collocato correttamente e allineato.

F Ne pas serrer les vis avant d'être sûr que le KIT est correctement monté et ajusté.

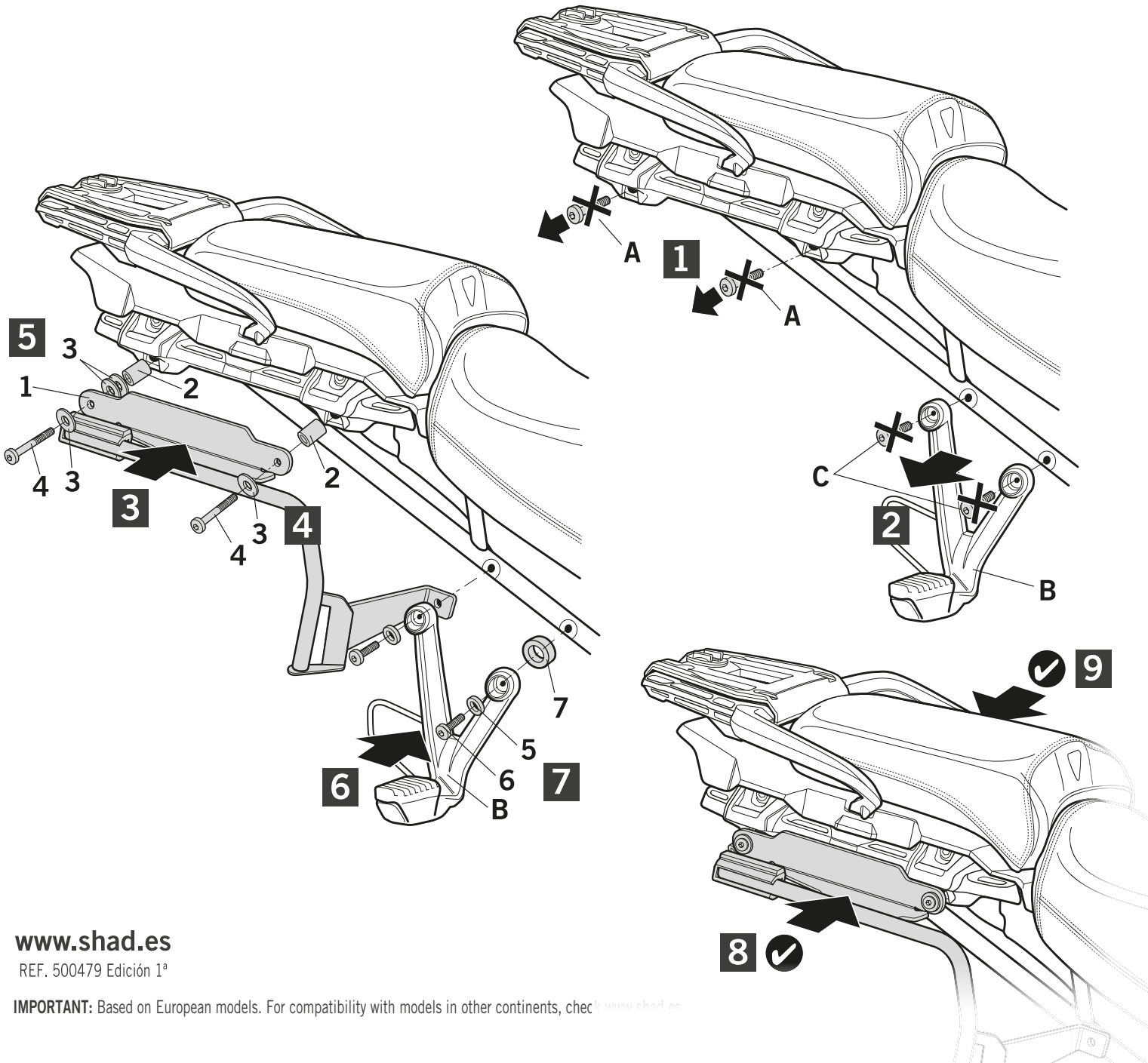

www.shad.es

REF. 500479 Edición 1ª

IMPORTANT: Based on European models. For compatibility with models in other continents, check www.shad.es